

Befüllbare Gasdruckfedern ab Lager

Bansbach
easylift

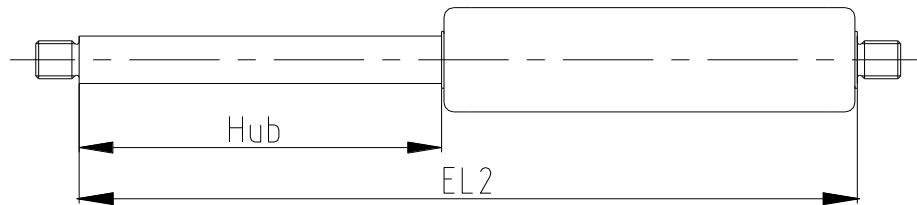

Bibus Art. Nr	Bansbach Bezeichnung	Hub	Länge EL2 ohne Anbauteile	Anschluss- Gewinde	Kraft max.
QS-15-20	V0V0F46-020-067/...N	20mm	67mm	M5	400N
QS-15-40	V0V0F46-040-107/...N	40mm	107mm	M5	400N
QS-15-50	V0V0F46-050-127/...N	50mm	127mm	M5	400N
QS-15-60	V0V0F46-060-147/...N	60mm	147mm	M5	400N
QS-15-80	V0V0F46-080-187/...N	80mm	187mm	M5	400N
QS-15-100	V0V0F46-100-227/...N	100mm	227mm	M5	400N
QS-15-120	V0V0F46-120-267/...N	120mm	267mm	M5	400N
QS-15-150	V0V0F46-150-327/...N	150mm	327mm	M5	400N
QS-19-50	B0N0F80-050-164/...N	50mm	164mm	M8	700N
QS-19-100	B0N0F80-100-264/...N	100mm	264mm	M8	700N
QS-19-150	B0N0F80-150-364/...N	150mm	364mm	M8	700N
QS-19-200	B0N0F80-200-464/...N	200mm	464mm	M8	700N
QS-19-250	B0N0F80-250-564/...N	250mm	564mm	M8	700N
QS-19-300	B0N0F80-300-664/...N	300mm	664mm	M8	700N
QS-22-50	H0N0F82-050-164/...N	50mm	164mm	M8	1300N
QS-22-100	H0N0F82-100-264/...N	100mm	264mm	M8	1300N
QS-22-150	H0N0F82-150-364/...N	150mm	364mm	M8	1300N
QS-22-200	H0N0F82-200-464/...N	200mm	464mm	M8	1300N
QS-22-250	H0N0F82-250-564/...N	250mm	564mm	M8	1300N
QS-22-300	H0N0F82-300-664/...N	300mm	664mm	M8	1300N
QS-22-350	H0N0F82-350-764/...N	350mm	764mm	M8	1300N
QS-22-400	H0N0F82-400-864/...N	400mm	864mm	M8	1300N
QS-22-500	H0N0F82-500-1064/...N	500mm	1064mm	M8	1300N
QS-28-100	D0M0F85-100-262/...N	100mm	262mm	M10	2500N
QS-28-150	D0M0F85-150-362/...N	150mm	362mm	M10	2500N
QS-28-200	D0M0F85-200-462/...N	200mm	462mm	M10	2500N
QS-28-250	D0M0F85-250-562/...N	250mm	562mm	M10	2500N
QS-28-300	D0M0F85-300-662/...N	300mm	662mm	M10	2500N
QS-28-350	D0M0F85-350-762/...N	350mm	762mm	M10	2500N
QS-28-400	D0M0F85-400-862/...N	400mm	862mm	M10	2500N

Diverse Anbauteile sind möglich, siehe Bansbach Katalog ab Seite 48

Lieferung innerhalb 24h!