

33.311

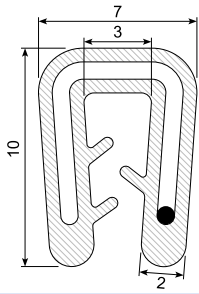

Edge trim: Silicone black
Grip range: 1 - 2 mm
Hardness: SH 60
Insert: Wire 18 x 0,76 mm. Stainless can be done, min. 500 m
Heat resistant 200° C
Silicone is FDA conform

33.510

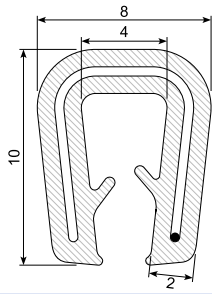

Edge trim: Silicone black
Grip range: 1 - 3 mm
Hardness: SH 60
Insert: Wire 26 x 0,76 mm. Stainless can be done, min. 500 m
Heat resistant 200° C
Silicone is FDA conform

33.312

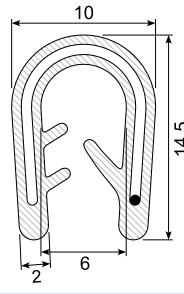

Edge trim: Silicone black
Grip range: 2 - 4 mm
Hardness: SH 60
Insert: Wire. Stainless can be done, min. 500 m
Heat resistant 200° C
Silicone is FDA conform

33.429

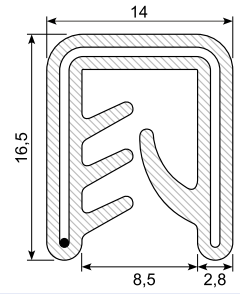

Edge trim: Silicone black
Grip range: 3 - 6 mm (5 - 7 mm)
Hardness: SH 60
Insert: Wire 39 x 0,76 mm. Stainless can be done, min. 500 m
Heat resistant 200° C
Silicone is FDA conform

33.511

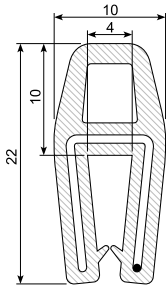

Edge trim: Silicone black
Grip range: 1,5 - 4 mm
Hardness: SH 50
Insert: Wire. Stainless can be done, min. 500 m
Heat resistant 200° C
Silicone is FDA conform

33.512

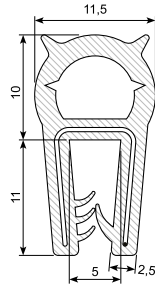

Edge trim: Silicone black
Grip range: 1 - 3,5 mm
Hardness: SH 50
Insert: Wire. Stainless can be done, min. 500 m
Heat resistant 200° C
Silicone is FDA conform

33.513

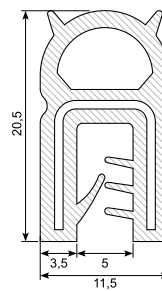

Edge trim: Silicone black
Grip range: 1,5 - 3,5 mm
Hardness: SH 50
Insert: Wire. Stainless can be done, min. 500 m
Heat resistant 200° C
Silicone is FDA conform

33.431A

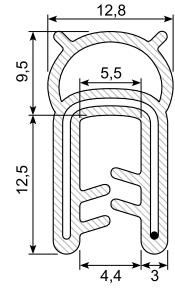

Edge trim: Silicone light grey RAL 7035
Grip range: 2 - 4 mm
Hardness: SH 60/60 Solid balloon
Insert: Wire. Stainless can be done, min. 500 m
Heat resistant 200° C.
Silicone is FDA conform

33.514

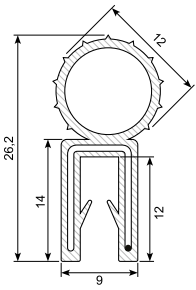

Edge trim: Silicone
Grip range: 1,5 - 3 mm
Hardness: SH 75
Insert: Wire. Stainless can be done, min. 500 m
Heat resistant 200° C
Silicone is FDA conform

33.515

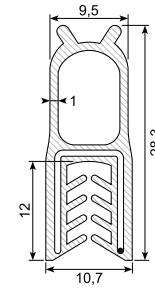

Edge trim: Silicone
Grip range: 1 - 2,5 mm
Hardness: SH 75
Insert: Wire. Stainless can be done, min. 500 m
Heat resistant 200° C
Silicone is FDA conform

33.516

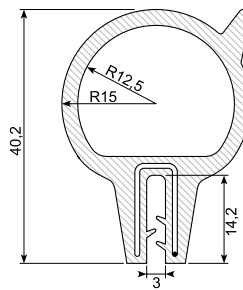

Edge trim: Silicone
Grip range: 2 - 3 mm
Hardness: SH 75
Insert: Wire. Stainless can be done, min. 500 m
Heat resistant 200° C
Silicone is FDA conform

33.517

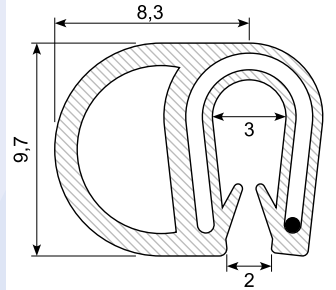

Edge trim: Silicone
Grip range: 2 - 3 mm
Hardness: SH 50
Insert: Wire. Stainless can be done, min. 500 m
Heat resistant 200° C
Silicone is FDA conform

33.518*

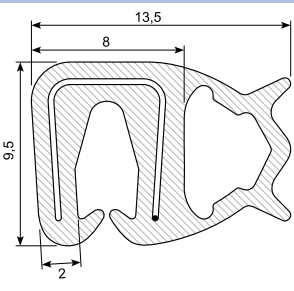

Edge trim: Silicone white
Grip range: 1,5 - 2,5 mm
Hardness: SH 60
Insert: Wire. Stainless can be done, min. 500 m
Heat resistant 200° C
Silicone is FDA conform
Min. order: 500 m

33.519

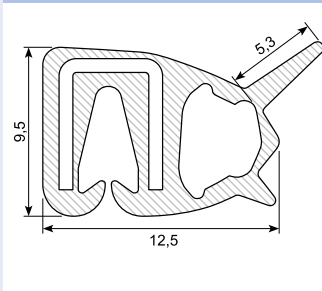

Edge trim: Silicone
Grip range: 1 - 2 mm
Hardness: SH 45
Insert: Wire. Stainless can be done, min. 500 m
Heat resistant 200° C
Silicone is FDA conform

33.520*

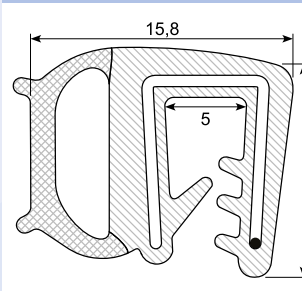

Edge trim: Silicone co-ex
Color: Black and redbrown
Grip range: 1,5 - 3 mm
Hardness: SH 60 / density 0,4
Insert: Wire. Stainless can be done, min. 500 m
Heat resistant 200° C
Min. order: 500 m

33.521

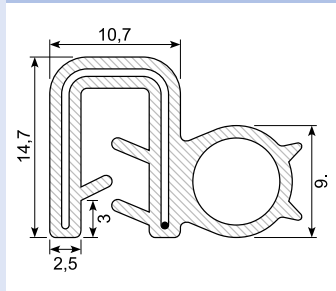

Edge trim: Silicone
Grip range: 1,5 - 4,5 mm
Hardness: SH 75
Insert: Wire. Stainless can be done, min. 500 m
Heat resistant 200° C
Silicone is FDA conform

* Skaffevare / Special order item

Silikonekantlister / Silicone edge trims

33.522 *

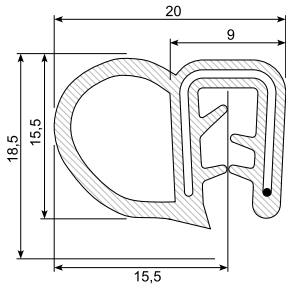

Edge trim: Silicone
 Grip range: 1 - 2,5 mm
 Insert: Wire. Stainless can be done, min. 500 m
 Heat resistant 200° C
 Silicone is FDA conform
 Min. order: 2.000 m

33.523 *

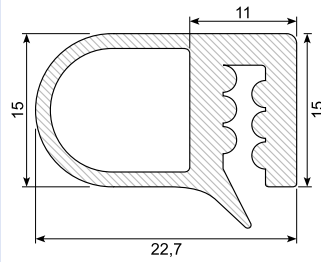

Edge trim: Silicone
 Grip range: 1,5 - 2,5 mm
 Hardness: SH 60
 Insert: Wire. Stainless can be done, min. 500 m
 Heat resistant 200° C
 Silicone is FDA conform
 Min. order: 500 m

33.524

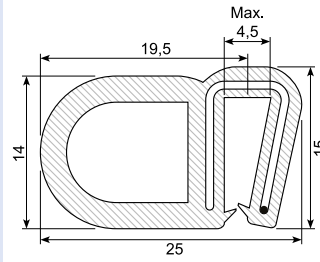

Edge trim: Silicone
 Grip range: 2 - 4 mm
 Hardness: SH 50
 Insert: Wire. Stainless can be done, min. 500 m
 Heat resistant 200° C
 Silicone is FDA conform

33.525

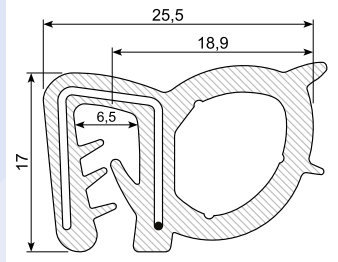

Edge trim: Silicone
 Grip range: 3 - 6 mm
 Hardness: SH 50
 Insert: Wire. Stainless can be done, min. 500 m
 Heat resistant 200° C
 Silicone is FDA conform

33.526 *

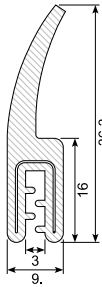

Edge trim: Silicone
 Grip range: 1 - 2,5 mm
 Hardness: SH 65
 Insert: Wire. Stainless can be done, min. 500m
 Heat resistant 200° C
 Silicone is FDA conform

33.527

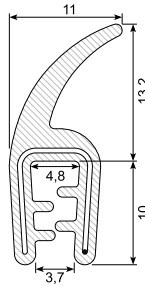

Edge trim: Silicone
 Grip range: 1 - 2,5 mm
 Hardness: SH 65
 Insert: Wire. Stainless can be done, min. 500m
 Heat resistant 200° C
 Silicone is FDA conform

33.528

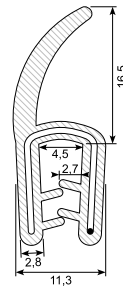

Edge trim: Silicone
 Grip range: 1 - 3 mm
 Hardness: SH 60
 Insert: Wire. Stainless can be done, min. 500m
 Heat resistant 200° C
 Silicone is FDA conform

33.529 *

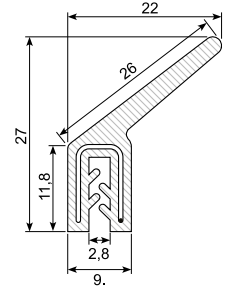

Edge trim: Silicone
 Grip range: 1 - 1,5 mm
 Hardness: SH 80
 Insert: Wire. Stainless can be done, min. 500 m
 Heat resistant 200° C
 Silicone is FDA conform
 Min. order: 500 m

33.530

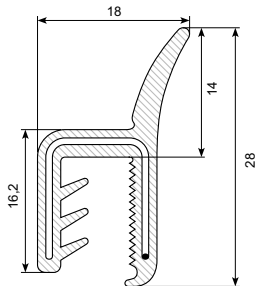

Edge trim: Silicone
 Grip range: 3,5 - 5 mm
 Hardness: SH 70
 Insert: Wire. Stainless can be done, min. 500 m
 Heat resistant 200° C
 Silicone is FDA conform

33.531 *

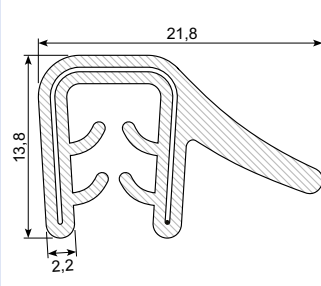

Edge trim: Silicone
 Grip range: 2,5 - 5,5 mm
 Hardness: SH 70
 Insert: Wire. Stainless can be done, min. 500 m
 Heat resistant 200° C
 Silicone is FDA conform
 Min. order: 100 m

33.532

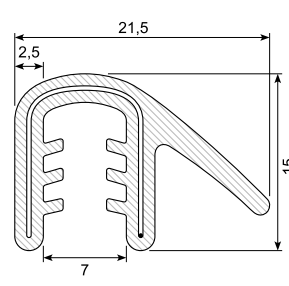

Edge trim: Silicone
 Grip range: 5,5 - 6,5 mm
 Hardness: SH 65
 Insert: Wire. Stainless can be done, min. 500 m
 Heat resistant 200° C
 Silicone is FDA conform